



PANELS FOR WASTEWATER PUMPING

Multico has been specializing in the manufacturing and automation of wastewater pumping processes over the last twenty years. Different models of control devices have been developed, always improving on its ever-growing expertise acquired throughout those years.

Here is the most recent controller for wastewater pumping. It is compatible for various types of simplex and duplex pumping application.

Standard Features:

- Industrial logic relay;
- Front door silkscreen with enhanced colors;
- Short circuit and overload protection for each motor branch;
- Finger safe components;
- Electrical schematics approved by an electrical engineer;
- Individual alarm lights with user acknowledgement;
- Alternating floats and pumps in case of equipment failure;
- Power supply are available from 120 to 600 Vac, 3 phases;
- 24 Vac control circuit;
- Pump individual elapsed time hour meter displayed on logic relay interface.

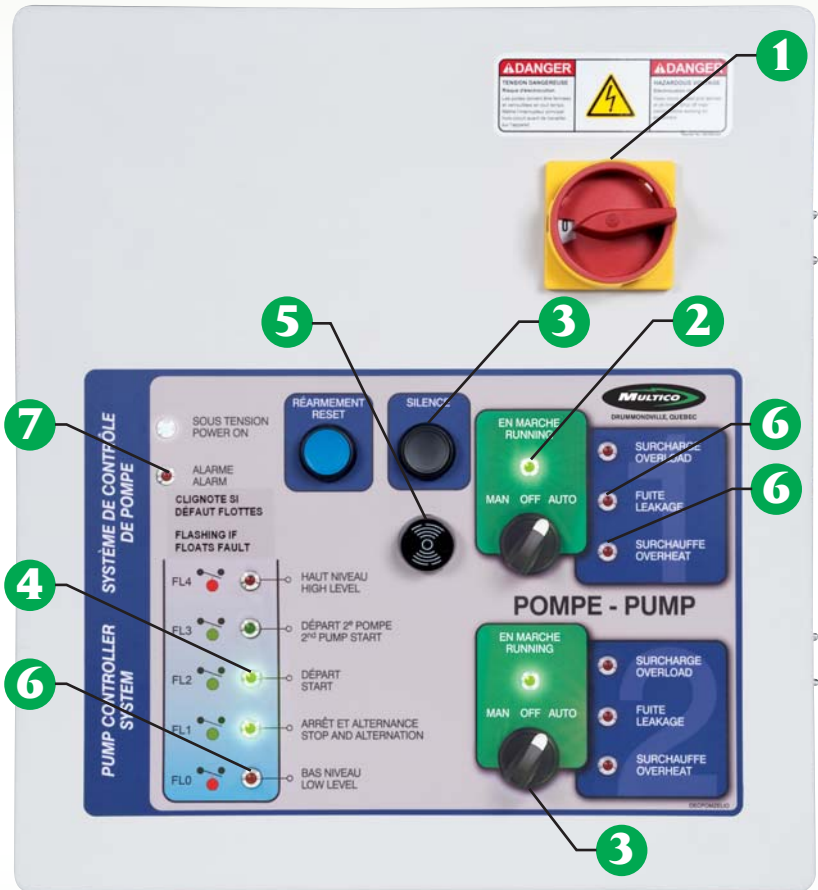

- 1 Main disconnect switch with padlocking handle
- 2 Sunlight visible LED lights
- 3 Industrial (22 mm) selectors and push buttons
- 4 Status light with flashing mode in case of flaw
- 5 Piezoelectric or vibrating sound alarm
- 6 Optional lights in case of low level, leakage and overheat
- 7 General alarm light



Systematic use of ferrules on wire ends

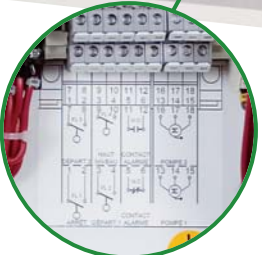

OPTIONS:

- Electrical enclosure type NEMA 1, 3R, 4, 4X and 12 in metal or polymeric material;
- Intrinsic safety barriers (CSA approval only);
- Swing panel;
- Heater with protective grid and adjustable thermostat;
- Stroboscopic alarm light with or without protective grid;
- Hour meter (door mounted model);
- Phone dialer;
- 3 phase monitoring relay detecting loss and phase inversion;
- Ammeter and/or voltmeter with phase selector;
- Soft starter;
- Variable frequency drive for pump.



Multico Electrique Inc. reserves the right to modify, at all times, the manufacturing and/or the characteristics and /or the design of its products without prior warning.

Multico Electrique Inc.

1000, Bergeron street, Drummondville (Quebec) Canada J2C 0C1

Tel.: 819 477-6777 • Fax: 819 478-0198

E-Mail: multico@multicoelectric.com